

12/31/16	Tax Map Revisions	SB
12/31/15	Tax Map Revisions	SB
12/31/12	Tax Map Revisions	SB
11/02/11	BL 551 L10 & BL 551.03 L107.02-Exempt	SB
09/03/10	Partial Vacation of Almon Avenue	JSE
REVISED	DESCRIPTION	
REV. BY	CHK.	

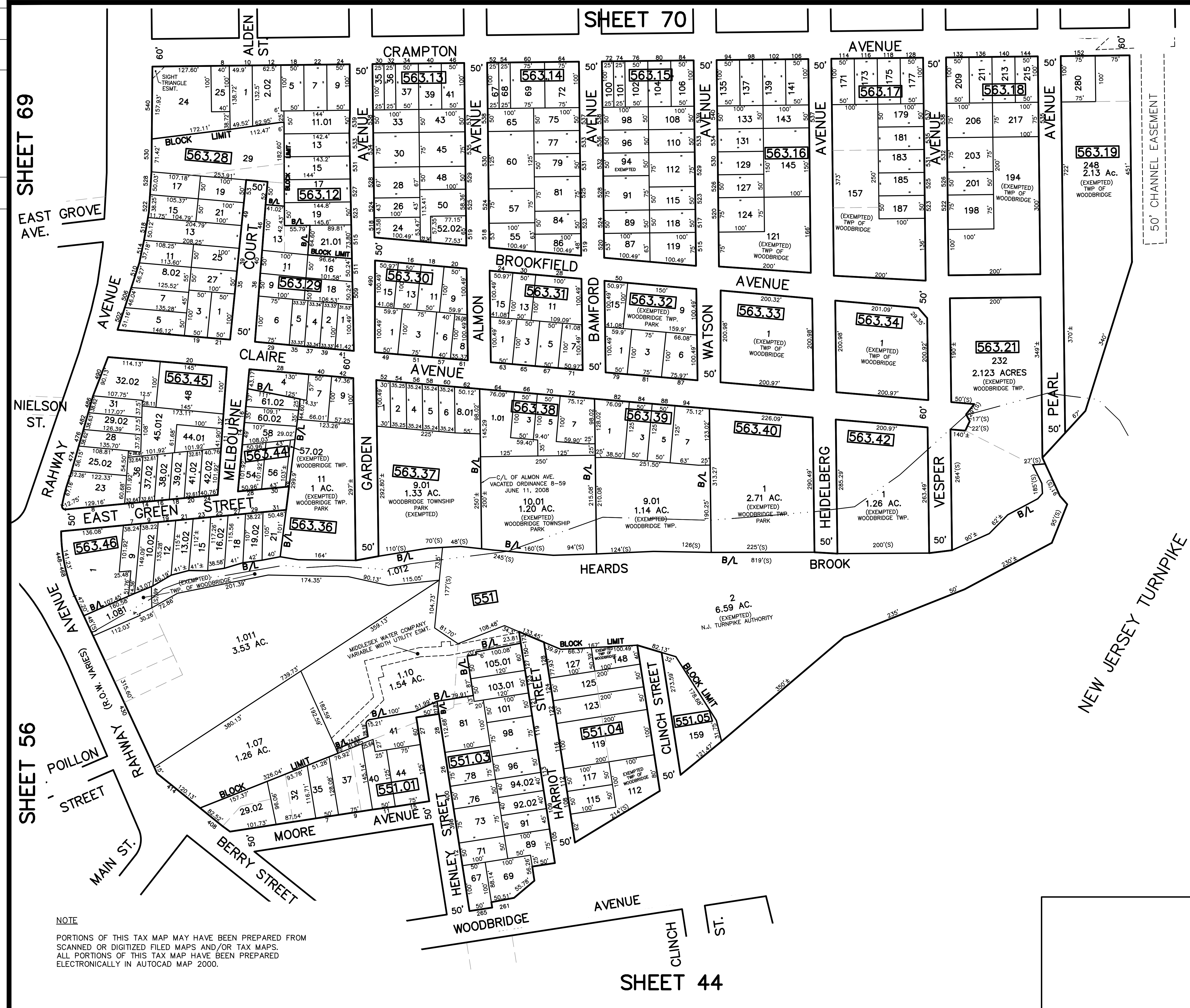

SHEET 69

SHEET 70

SHEET 58

SHEET 56

SHEET 44

NOTE  
 PORTIONS OF THIS TAX MAP MAY HAVE BEEN PREPARED FROM  
 SCANNED OR DIGITIZED FILED MAPS AND/OR TAX MAPS.  
 ALL PORTIONS OF THIS TAX MAP HAVE BEEN PREPARED  
 ELECTRONICALLY IN AUTOCAD MAP 2000.

TAX MAP  
 WOODBRIDGE TOWNSHIP  
 MIDDLESEX COUNTY, NEW JERSEY  
 SCALE : 1"= 100' DATE : JUNE 2008  
 MICHAEL J. McGURL, P.L.S.  
 CME ASSOCIATES  
 3141 BORDENTOWN AVENUE, PARLIN  
 NEW JERSEY, 08859